



Flush Mount Fingerprint Terminal & Mobile Key Solution

# FMD-10



(UNIS-B)

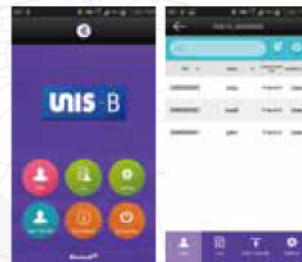

(imkey)

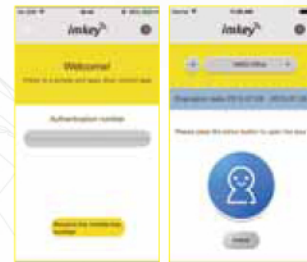

## Features



Mobile Key Support



Flush Mount Installation



Touch Bell Function



Patented Live & Fake Finger Detection  
- Optical sensor and algorithm detect fake fingers (paper, film, silicone, rubber and gelatin)

## Specification

Supply Voltage	DC 12V or 24V	Max Users	1,000
Log Capacity	10,000	Relay / Buzzer	1 Relay / 1 Buzzer
Communication	Bluetooth, RS485, Wiegand out	Dimension	72 x 111.6 x 11 mm

